

No 15.

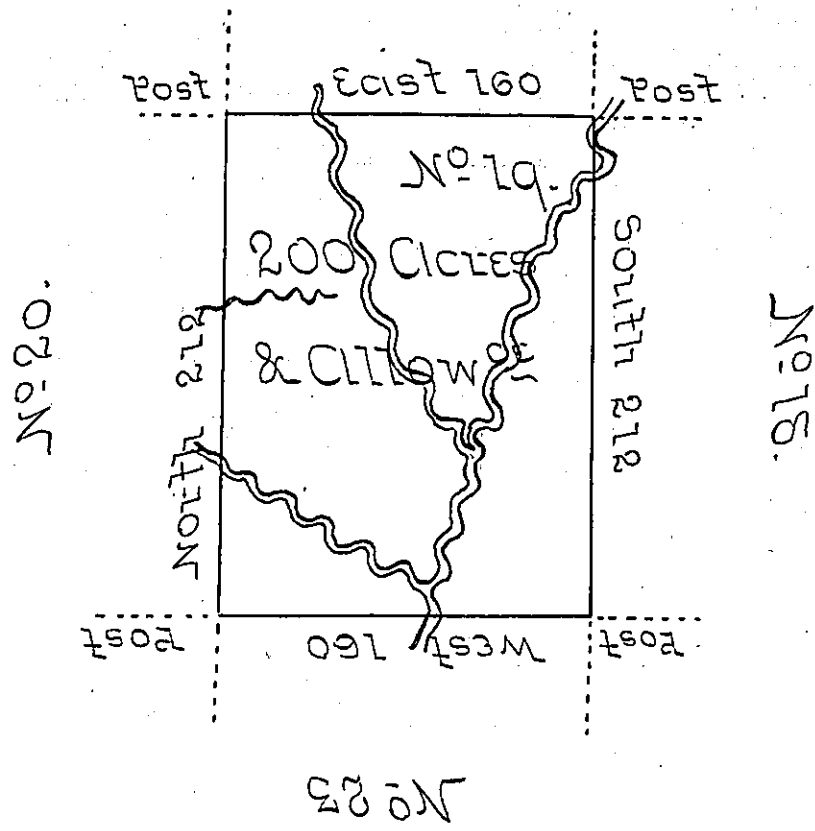

Situate on Camp Creek between the fourth & fifth Parallel in that Part of District No 3 to me allotted on the North side of the River Ohio being Part of the Land appropriated for the Purpose of Redeeming & paying off the Certificates of Depreciation &c<sup>a</sup> Surveyed in the Month of June 1785 Pursuant to Instructions from John Lukens Esquire Surveyor Gen<sup>l</sup> Dated at Philad<sup>a</sup> the fifth day of March 1785 -

Wm Breeding U.S.

*IN TESTIMONY* that the above is a copy of the original remaining on file in the Department of Internal Affairs of Pennsylvania, made conformably to an Act of Assembly approved the 16th day of February, 1833, I have hereunto set my Hand and caused the Seal of said Department to be affixed at Harrisburg, this thirty first day of October 1905.

*Geo A P Brown*  
Secretary of Internal Affairs.